

105° 24' 5.562" W
42° 45' 40.458" N

Marlboro Pasture

Douglas, Wyoming

Fenced Pasture

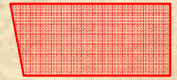

NOTE: For visual aid only - accuracy not guaranteed!

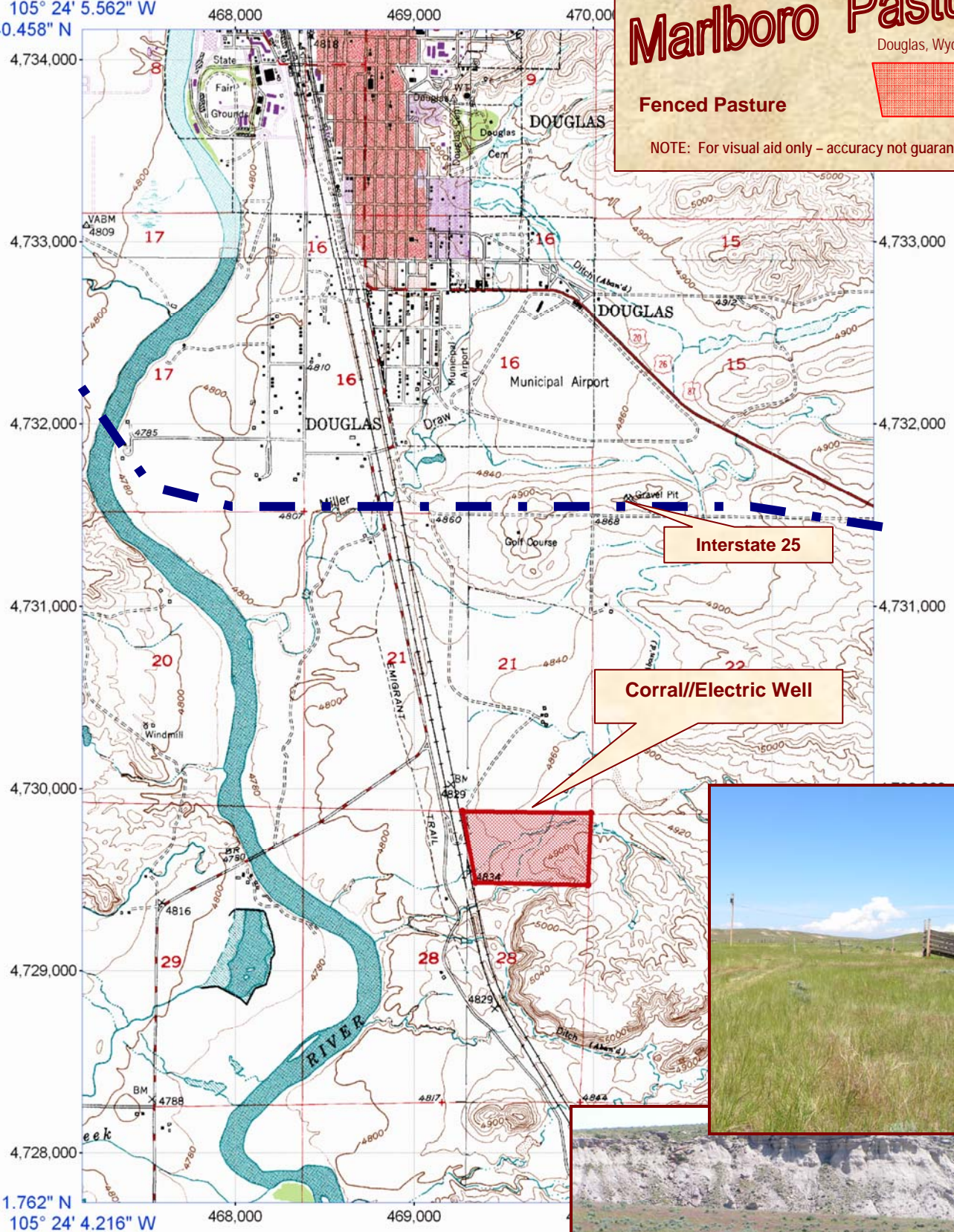

Interstate 25

Corral//Electric Well



42° 42' 11.762" N
105° 24' 4.216" W

1927 North American Datum; UTM grid zone 13
Generated by BigTopo7 (www.igage.com)
Map compiled from USGS Quads: Douglas;
WY Antelope Creek; WY Chalk Buttes;
WY Irvine; WY

UTM Grid and 2009 Magnetic North
Declination at Center of Sheet
GN to TN 0.254" (5 mils)
TN to MN 9.701" (172 mils)

